

Assembly Instructions :

amhil AFS19 Class 1 Face Shield – Disposable

Intended Use: to be used by healthcare and industry personnel to provide full barrier splash protective coverage of front and side of face

Pieces:

Part A – Strap for around the head



Part B – Face Shield

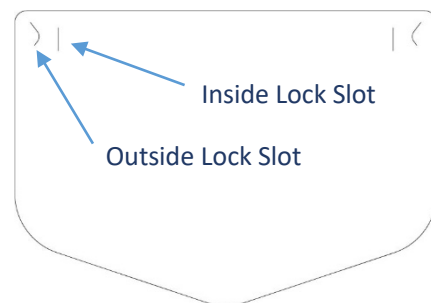

Step 1: Attaching Strap to Shield

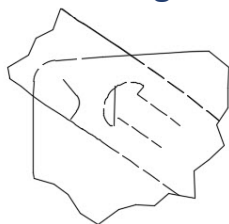

Step 1.1 Insert Shield Lock Tab from Part A on angle into Inside Lock Slot on Part B

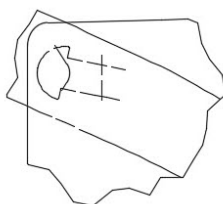

Step 1.2 Continue to thread Lock Tab through Outside Lock Slot of Part B

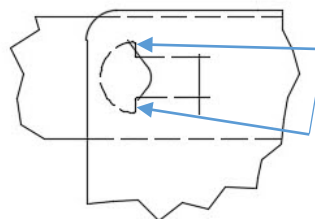

Ensure hooked on both sides

Step 1.3 Ensure Lock Tab is Engaged. Repeat for other side of Shield

Step 2: Fitting Strap to Head Size

Step 2.1 Wrap Strap around head, select Strap Lock Slot for desired fit

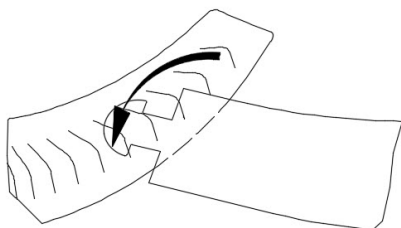

Step 2.2 Insert Strap Lock Tab on angle into selected Slot, ensure Slot is entered from outside surface

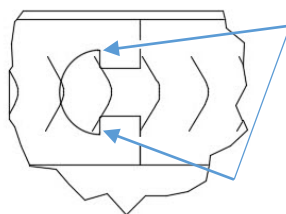

Ensure hooked on both sides

Step 2.3 Ensure Outer Lock Tab is Engaged

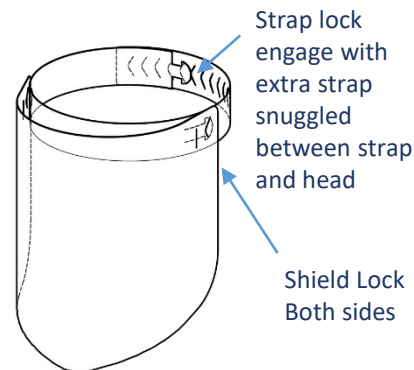

Product Specifications

Name: AFS19
Dimensions: Shield: 13.5" x 9.5" (343mm x 241mm)
Strap (adjustable): 26.25" x 1.5" (667mm x 38mm)
Package: 100 Shields, 100 Straps
Material: 100% PET, 100% Recyclable

Manufacturing Facility

400 Traders Blvd East
Mississauga, ON
L4Z 1W7
1-800-521-6695
sales@amhil.com

Instructions d'assemblage :

amhil AFS19 Classe 1 Visière –Jetable

Usage prévue : Destiné au personnel médical et industriel assurant une protection complète contre les éclaboussures sur le devant et les côtés du visage

Pièces:

Partie A – Bandeau pour contour de la tête

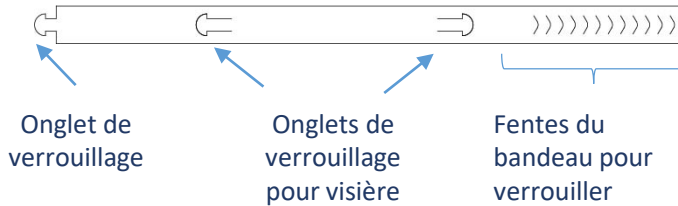

Partie B – Visière

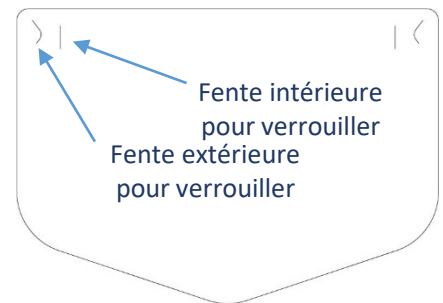

Étape 1: Comment verrouiller le bandeau à la visière

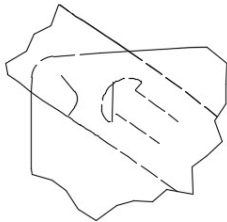

Étape 1.1 Insérez l'onglet de verrouillage Partie A en angle dans la fente intérieure de la Partie B

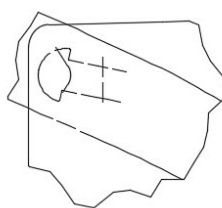

Étape 1.2 Insérez l'onglet verrouillable à travers la fente extérieure de la partie B

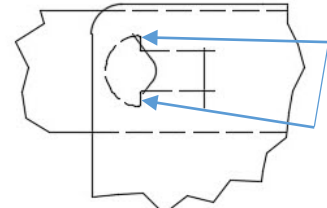

Assurez-vous que les 2 côtés sont barrés

Étape 1.3 Assurez-vous que l'onglet est verrouillé. Répétez de l'autre côté

Étape 2: Bandeau ajustable à la taille de la tête

Étape 2.1 Placez le bandeau autour de la tête, sélectionnez la fente désirée

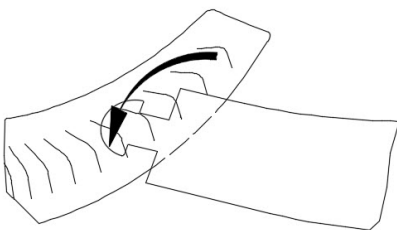

Étape 2.2 Insérez l'onglet en angle dans la fente choisie, l'onglet doit apparaître sur la surface extérieure lorsque verrouillé

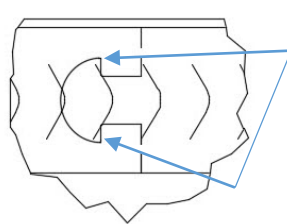

Assurez l'ancrage aux 2 côtés

Étape 2.3 S'assurer que l'onglet est bien enclenché

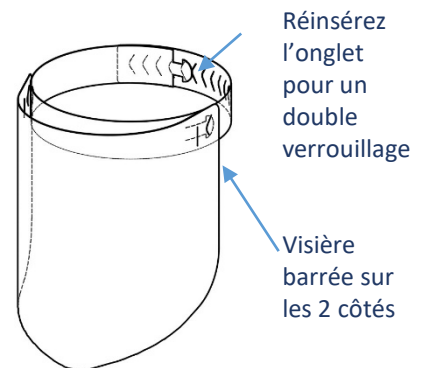

Spécifications du produit

Nom: AFS19
Dimensions: Visière: 13.5" x 9.5" (343mm x 241mm)
Bandeau (ajustable): 26.25" x 1.5" (667mm x 38mm)
Contenu: 100 visières, 100 bandeaux
Matériaux: 100% PET, 100% Recyclable

Adresse de manufacture

400 Traders Blvd East
Mississauga, ON
L4Z 1W7
1-800-521-6695
sales@amhil.com